

Monomoy Ballroom Specs:

Dimensions: 48' x 72'

Square Feet: 4,500

Room Height: 14.5'

Monomoy Ballroom – Classroom  
Setup

-6ft x 18in Banquet Tables

-3 people per table

-Stage has been removed

-Food & Beverage to be set in the  
foyer

TOTAL SET: 180 people

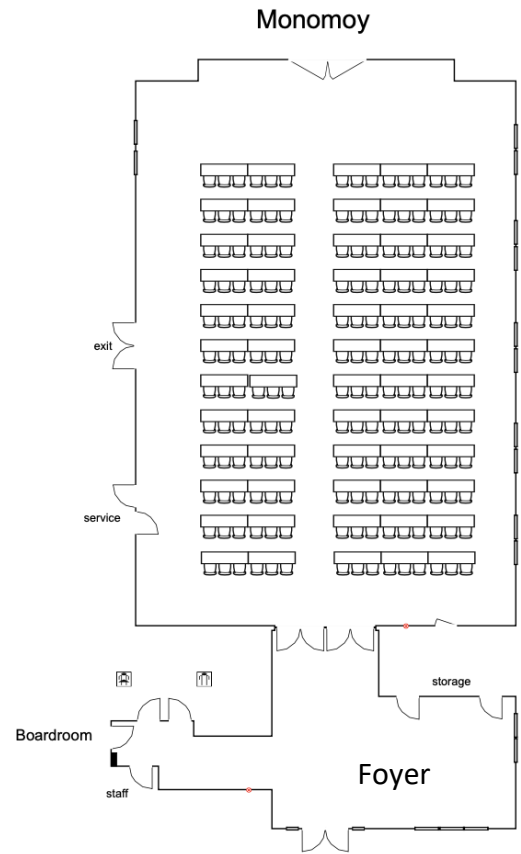

Monomoy Ballroom – U-Shape  
Setup

-6ft x 30in Banquet Tables

-3 people per table

-Stage has been removed

-Food & Beverage to be set in the  
foyer

TOTAL SET: 63 people

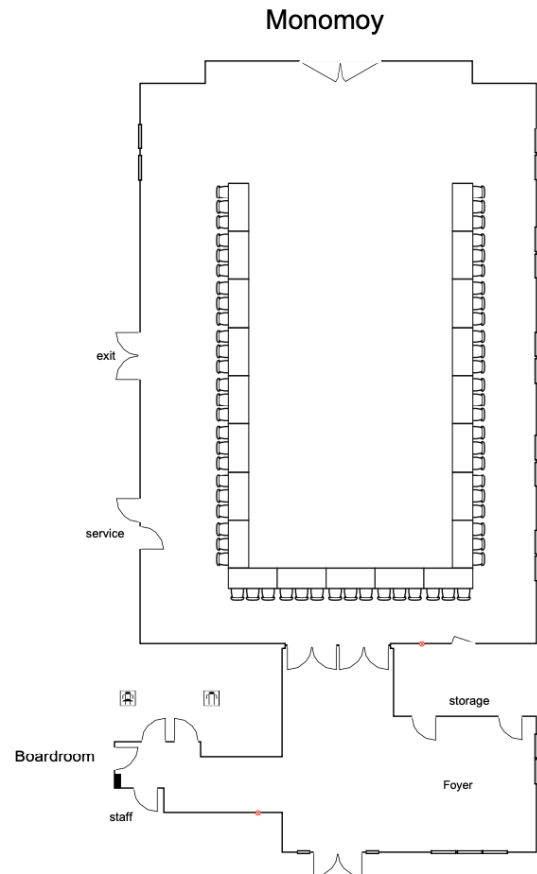

Monomoy Ballroom – Hollow  
 Square Setup  
 -6ft x 30in Banquet Tables  
 -3 people per table  
 -Stage has been removed  
 -Food & Beverage to be set in the  
 foyer  
 TOTAL SET: 78 people

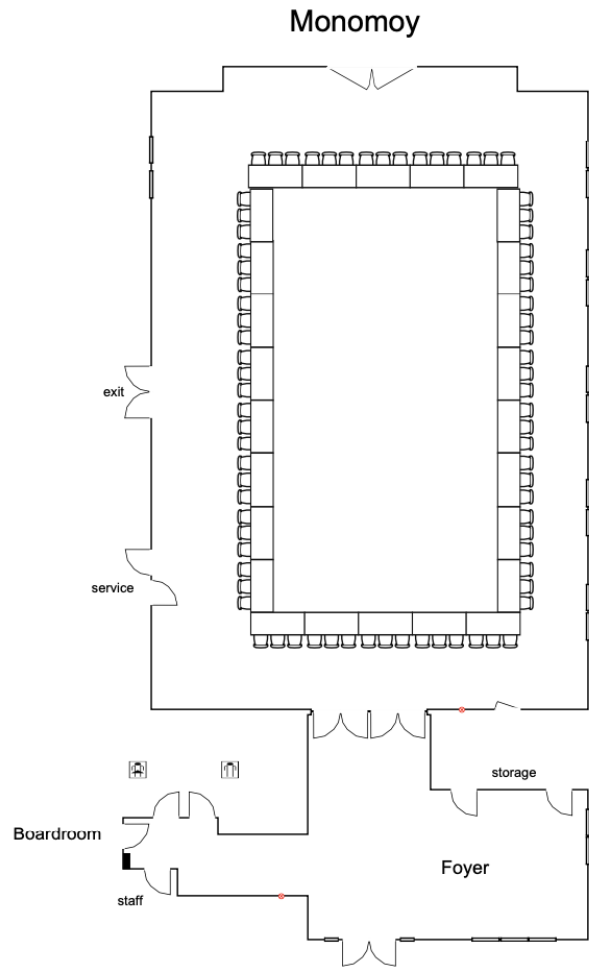

Monomoy Ballroom – Theater  
 Setup  
 -Banquet Chairs  
 -20 People per Row with Center  
 Aisle  
 -Stage at Front of room  
 -Food & Beverage to be set in the  
 foyer  
 TOTAL SET: 280 people

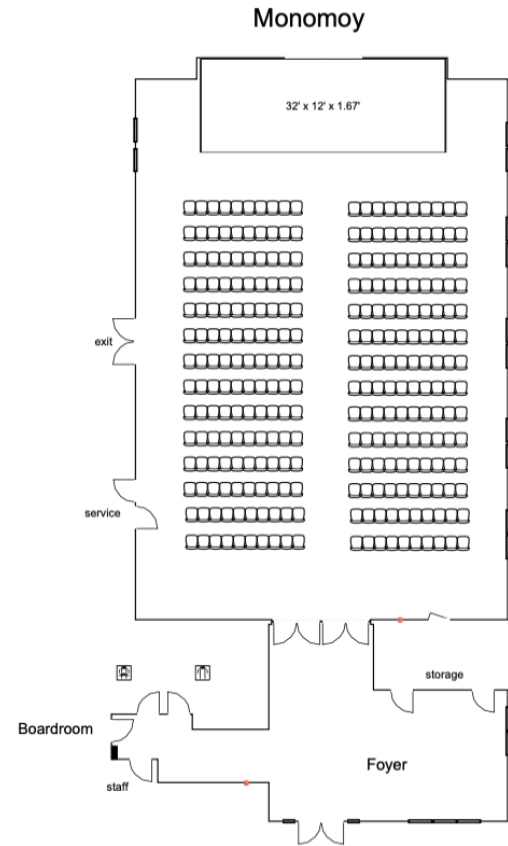

**Monomoy Ballroom – Conference Setup**  
 -6ft x 30in Banquet Tables  
 -3 people per table  
 -Stage at Front of room  
 -Food & Beverage to be set in the foyer  
**TOTAL SET: 32 people**

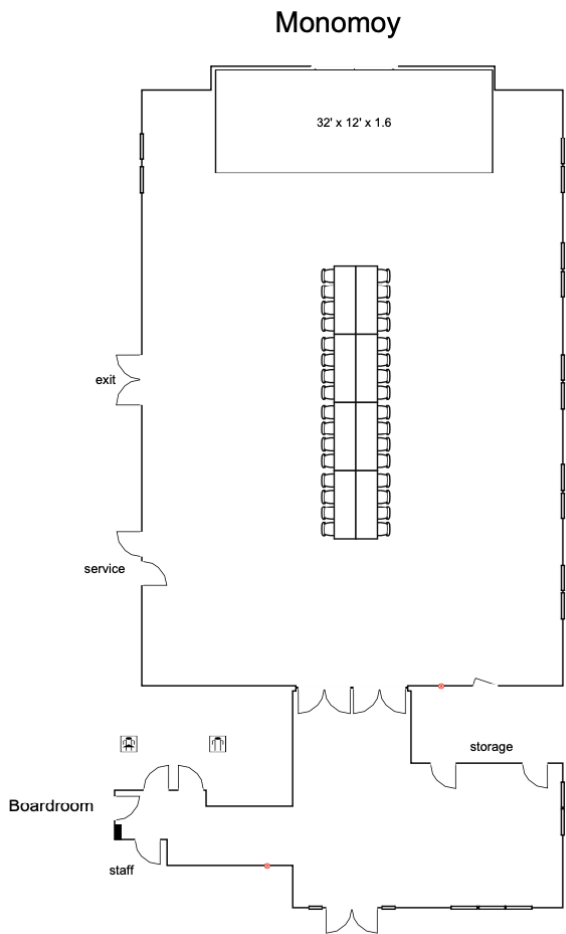

**Monomoy Ballroom – Meal Setup**  
 -5ft Rounds Tables  
 -8 people per table  
 -Stage have been removed  
 -Food & Beverage to be set in the foyer  
**TOTAL SET: 192 people**

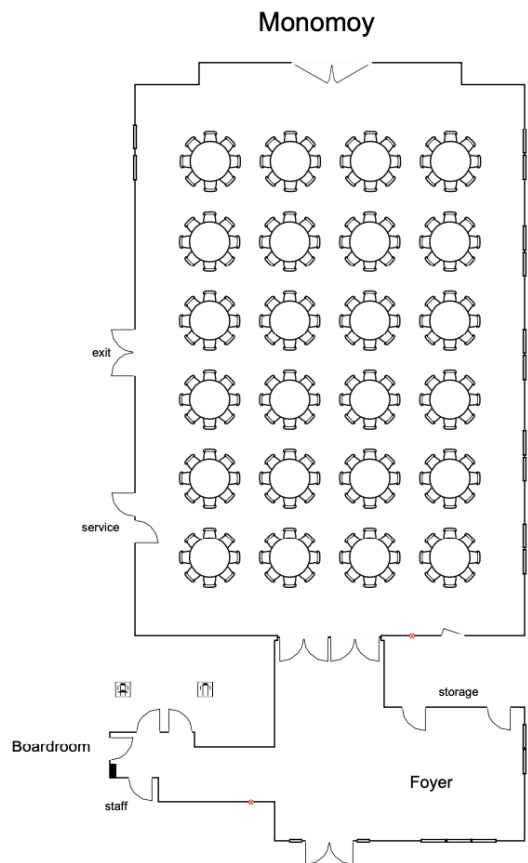

**Monomoy Ballroom – Meal Setup**

- 5ft Rounds Tables
- 8 people per table
- Stage have been removed
- Buffet set in back of room and foyer
- Bar setup in foyer
- TOTAL SET: 168 people

